

# Applying Floor Finish with Backpack Applicator



Provided by:



Great Western Supply Co.

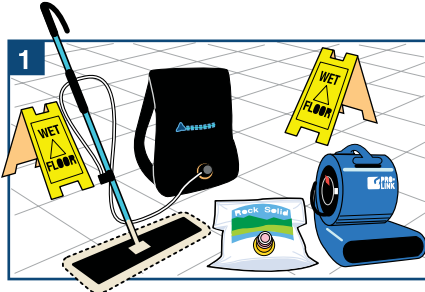

1 Gather equipment.



2 Wear proper personal protective equipment.

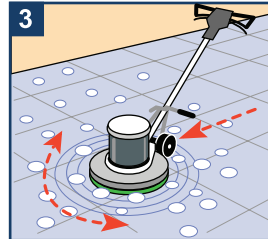

3 Strip or top scrub the floor appropriately before applying any finish. Make sure there is no residue left on the floor. Rinse if needed.

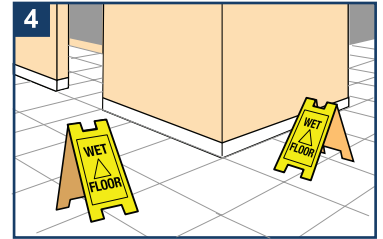

4 Place wet floor signs at all entranceways.

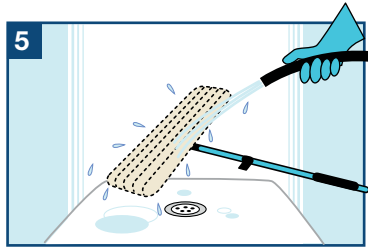

5 Rinse mop out with clean water.

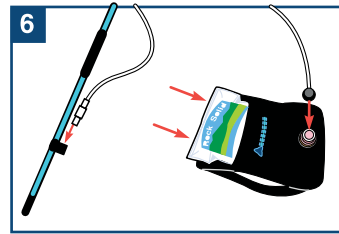

6 Insert bag of wax into back pack and connect hose ends.

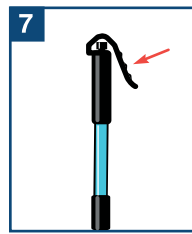

7 Squeeze the trigger to start the flow of finish to the mop head.

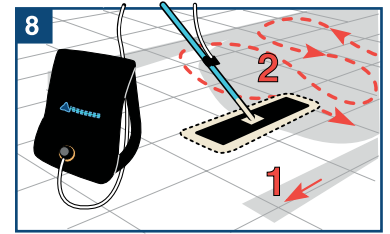

8 Outline the area using the figure 8 motion, filling in the area with finish. On the first coat, leave 6-12 inches of space from walls.

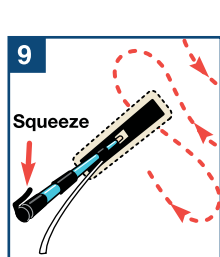

9 Squeeze the trigger for more finish as needed. Squeeze when mop is in front of you versus on the turns.

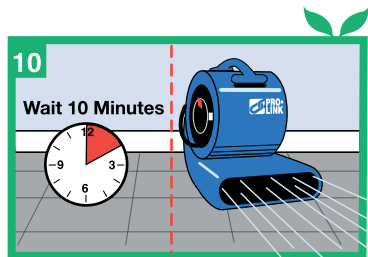

10 After at least 10 minutes, place a floor fan above the finish to speed the dry time. Ensure the fan is not blowing onto the finish.

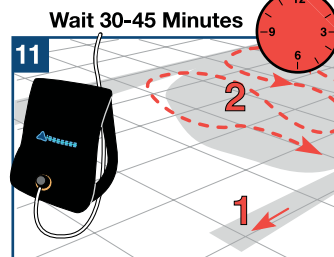

11 Wait 30-45 Minutes. Recoat when the floor finish is dry to the touch: 30 to 45 minutes depending on the weather. Temperature, humidity and ventilation will affect dry time.

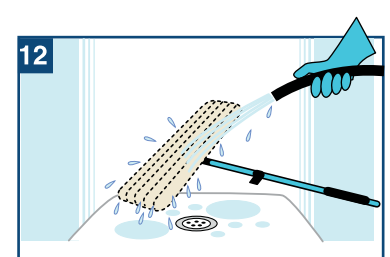

12 Properly clean and store equipment.

= Green Cleaning Process

## Green Cleaning Tips

- Select appropriate floor finishes that are extremely durable to minimize the strip out or top scrub process.
- Build a solid base of floor finish.
- Develop a program to maintain the floors on a regular basis, improving the life of the floor finish.
- Properly maintain entranceways with mats to stop soil from entering the facility and to protect the floor finish.

## Great Western Supply Company

116 East 53rd Street  
Davenport, IA 52806

**563-445-6644**

Fax: 563-445-6654

[www.greatwesternsupply.com](http://www.greatwesternsupply.com)

Pro-Link, Inc.

Telephone: 800-74-LINKS

[www.prolinkhq.com](http://www.prolinkhq.com)

# Applying Floor Finish with Backpack Applicator



Provisto Por:



Great Western Supply Co.

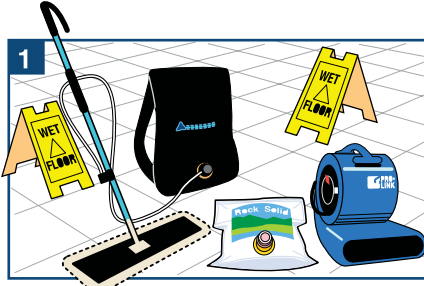

1 Gather equipment.



2 Wear personal protective equipment.



3 Strip or top scrub the floor appropriately before applying any finish. Make sure there is no residue left on the floor. Rinse if needed.

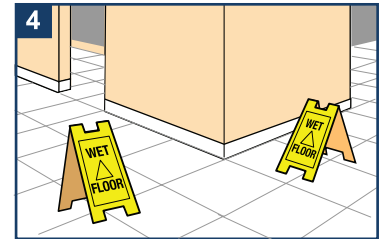

4 Place wet floor signs at all entranceways.

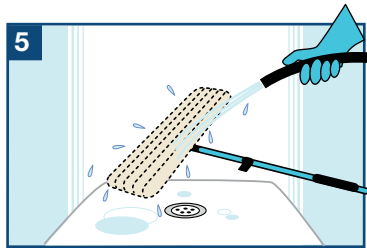

5 Rinse mop out with clean water.

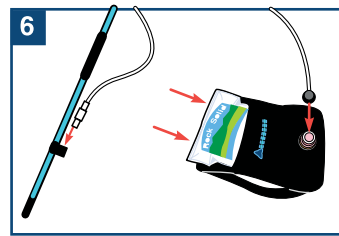

6 Insert bag of wax into back pack and connect hose ends.

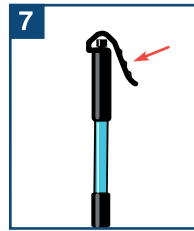

7 Squeeze the trigger to start the flow of finish to the mop head.

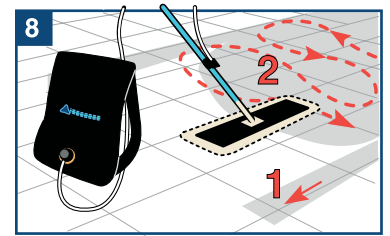

8 Outline the area using the figure 8 motion, filling in the area with finish. On the first coat, leave 6-12 inches of space from walls.

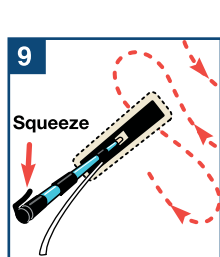

9 Squeeze the trigger for more finish as needed. Squeeze when mop is in front of you versus on the turns.

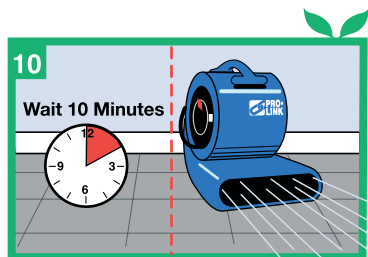

10 After at least 10 minutes, place a floor fan above the finish to speed the dry time. Ensure the fan is not blowing onto the finish.

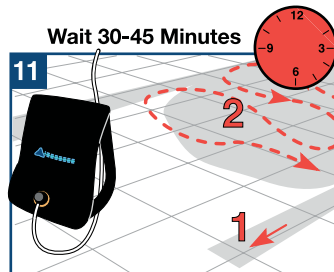

11 Wait 30-45 Minutes. Recoat when the floor finish is dry to the touch: 30 to 45 minutes depending on the weather. Temperature, humidity and ventilation will affect dry time.

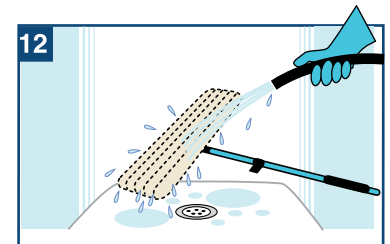

12 Properly clean and store equipment.

## = Proceso de Limpieza Verde

### Consejos de Limpieza Verde

- Seleccione los productos de sacar brillo apropiados que son más durables para reducir el proceso de restregar.
- Construya una base sólida de brillo en el piso.
- Desarrolle un programa de mantenimiento para mejorar la vida del brillo del piso.
- Mantenga las entradas apropiadamente con tapetes para prevenir que el polvo entre al piso y también para proteger el brillo del piso.

### Great Western Supply Company

116 East 53rd Street  
Davenport, IA 52806

**563-445-6644**

Fax: 563-445-6654

[www.greatwesternsupply.com](http://www.greatwesternsupply.com)

Pro-Link, Inc.

Telephone: 800-74-LINKS

[www.prolinkhq.com](http://www.prolinkhq.com)